

CLEARLENS instrument assembly

Smith+Nephew

CLEARLENS
Tracking Technology

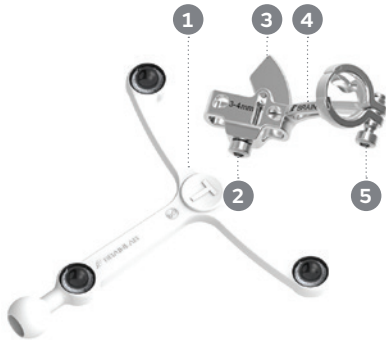

Overview

CLEARLENS Bone Reference tibia/femur contains the following parts:

- 1 CLEARLENS Tracking Array tibia/femur
- 2 Fixing Screw
- 3 Wedge
- 4 CLEARLENS Bone Fixator 2-Pin
- 5 Fixing Screw

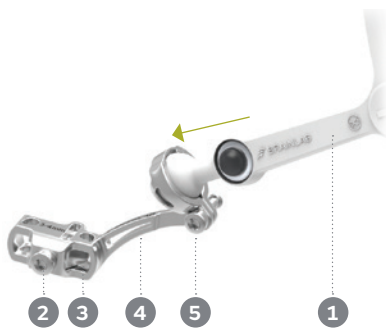

Assemble CLEARLENS Bone Reference tibia/femur

- Fully open the screw. 5
- Push CLEARLENS Tracking Array tibia/femur 1 into CLEARLENS Bone Fixator 2-Pin. 4
- Fix CLEARLENS Bone Fixator 2-Pin 4 onto the Schanz screws and tighten the screw. 2
- Check visibility and array alignment on the navigation screen, then secure it using the screw. 5

Note: Ensure that the array's ball joint is securely tightened prior to registration and surgery.



Disassemble CLEARLENS Bone Reference tibia/femur

- Fully open screws 2 and 5.
- Detach and dispose of CLEARLENS Tracking Array tibia/femur. 1
- Pivot the wedge 3 so that the inner thread can be cleaned and disinfected.

Note: Always dispose of CLEARLENS Tracking Array tibia/femur after use.



Reprocess CLEARLENS Bone Reference tibia/femur

Follow the instructions in the cleaning, disinfection and sterilization guide to perform the following steps:

- Disassemble
- Pretreat
- Automatic cleaning and disinfection
- Steam sterilization

How to use CLEARLENS Pointer

Overview

CLEARLENS Pointer contains the following parts:

- 1 CLEARLENS Tracking Array Pointer
- 2 CLEARLENS Pointer Handle - Knee

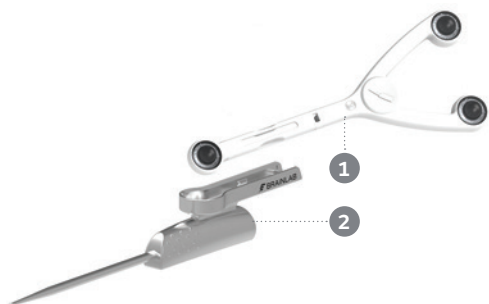

Assemble CLEARLENS Pointer

- Clip CLEARLENS Tracking Array Pointer 1 into CLEARLENS Pointer Handle - Knee. 2
- Ensure that the array is fully seated within the interface.

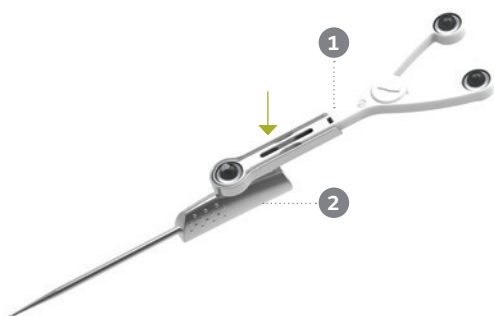

Disassemble CLEARLENS Pointer

- Detach and dispose of CLEARLENS Tracking Array Pointer. 1

Note: Always dispose of CLEARLENS Tracking Array Pointer after use.

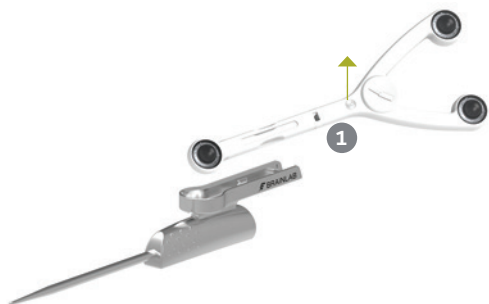

Reprocess CLEARLENS Pointer

Follow the instructions in the cleaning, disinfection and sterilization guide to perform the following steps:

- Disassemble
- Pretreat
- Automatic cleaning and disinfection
- Steam sterilization



How to use CLEARLENS Plane Tool



Overview

CLEARLENS Plane Tool contains the following parts:

- 1 CLEARLENS Tracking Array Plane Tool
- 2 CLEARLENS Knee Plane Tool - Interface
- 3 Bone Verification Plate or
- 4 Cutting Block Adapter



Assemble CLEARLENS Plane Tool

- Attach CLEARLENS Knee Plane Tool - Interface 2 onto Bone Verification Plate 3 or the Cutting Block Adapter.
- Clip CLEARLENS Tracking Array Plane Tool 1 into CLEARLENS Knee Plane Tool. 2
- Ensure that the array is fully seated within the interface.

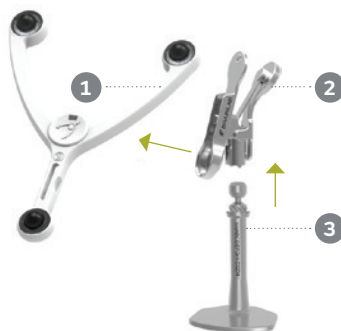

Disassemble CLEARLENS Plane Tool

- Detach and dispose of CLEARLENS Tracking Array Plane Tool. 1
- Press on the interface lever 2 and detach the Bone Verification Plate 3 or the Cutting Block Adapter.

Note: Always dispose of CLEARLENS Tracking Array Plane Tool after use.



Reprocess CLEARLENS Plane Tool

Follow the instructions in the cleaning, disinfection and sterilization guide to perform the following steps:

- Disassemble
- Pretreat
- Automatic cleaning and disinfection
- Steam sterilization

Smith & Nephew, Inc.
1450 Brooks Road
Memphis, Tennessee 38116
USA

www.smith-nephew.com

®Trademark of Smith+Nephew
All Trademarks acknowledged
©2020 Smith & Nephew, Inc.
24766 V1 04/20

